

RECOMMENDED PCB LAYOUT
(Top View)

NOTE:
1. MATERIAL:
1.1 INSULATOR: PBT+30%GF UL 94V-0 BLUE;
1.2 CONTACT: 4P1N C5191R-H(T=0.25mm),
5P1N C2680R-H(T=0.25mm);

- 1.3 SHELL: BRASS(T=0.40mm)
2. ELECTRICAL CHARACTERISTICS:
2.1 CONTACT RESISTANCE: 30mΩ MAXIMUM
- 2.2 CONTACT CURRENT RATING: 1.5A
- 2.3 DIELECTRIC WITHSTANDING VOLTAGE: 500 V R.M.S.
- 2.4 INSULATION RESISTANCE 1000 MEGOHMS MIN
- 2.5 OPERATING TEMPERATURE: -40° C ~ 85° C
3. MECHANICAL CHARACTERISTICS:
3.1 MATING FORCE: 3.57kg MAX
- 3.2 UNMATING FORCE: 1.02kg MIN
- 3.3 DURABILITY: MANDATORY: 5,000 CYCLES
4. PLATING
4.1 TERMINAL: GOLD 15u" MIN. OVER 50u" MIN NICKEL,
80u" MIN TIN OVER 50u" MIN. NICKEL ON SOLDER AREA.
4.2 SHELL: 80u" MIN. NICKEL.

Pin NUMBER	SIGNAL NAME
1	VBUS
2	D-
3	D+
4	GND
5	Stda_SSRX-
6	Stda_SSRX+
7	GND_DRAIN
8	Stda_SSTX-
9	Stda_SSTX+
Shell: Shield	

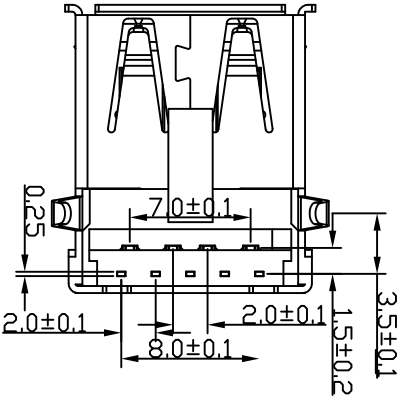

ECN(DCN) NO.	REV.	DATE	DESCRIPTION	CHANGE	APVD	APVD	UNIT	mm	SIZE	A4	Third Angle Protection
	R4	2013/10/29	REVISED	JOHN			Drawing NO	J25-0157	Scale	1 : 1	
	R3	2013/06/13	REVISED	JOHN			Customers Drawing	USB 3.0 AF R/A DIP	Sheet	1 of 2	
	R2	2013/05/27	REVISED	JOHN			Part NO.	J25-0157-01	Scale	1 : 1	
	R1	2013/04/16	NEW	JOHN			Drawing NO	J25-0157	Sheet	1 of 2	

TOLERANCES UNLESS OTHERWISE SPECIFIED
X. ±0.30 ANG: ±5°
X ±0.25
XX ±0.20
.XXX ±0.15

2013/04/16
DWN JOHN

CHKD
Drawing NO: J25-0157
Part NO: J25-0157-01
Scale: 1:1
Sheet: 1 of 2

JS HAOGUO(Zhongxiang) Limited Company