

NOTE:
PRODUCTS MUST CONFORM TO JS SPEC JS-GC03143-A1.

1.MATERIAL:
HOUSING: LCP; UL94V-0; COLOR:BLACK
CAP: LCP; UL94V-0; COLOR:BLACK
CONTACT: BRASS.
BOARDLOCK: BRASS

2.FINISH:
CONTACT: (SEE TABLE) GOLD PLATING ON CONTACT AREA.
100μ" MIN MATTE-TIN PLATING ON SOLDER TAIL,
WITH ENTIRE CONTACT UNDERPLATED 50μ" MIN NICKEL.
BOARDLOCK: 100μ" MIN. MATTE-TIN OVER 50μ" MIN. NICKEL PLATED.

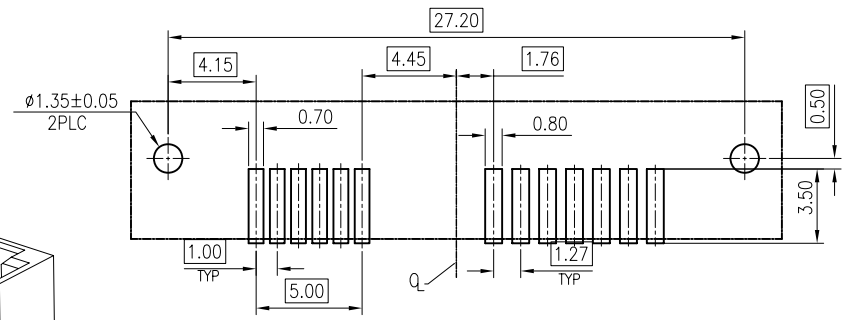
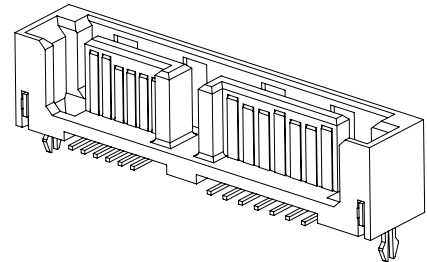
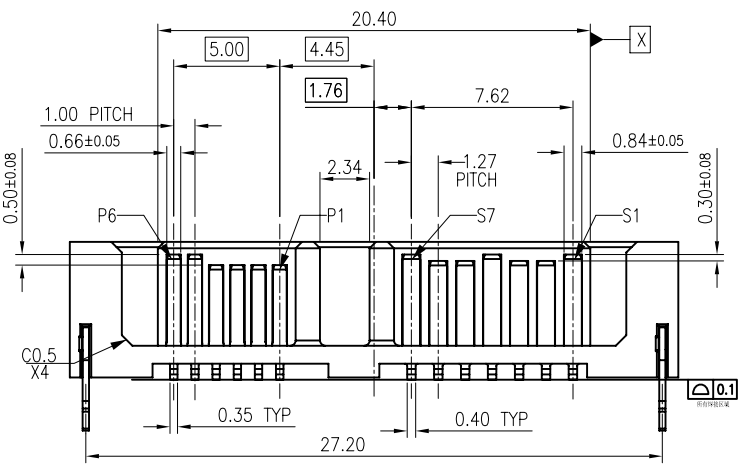
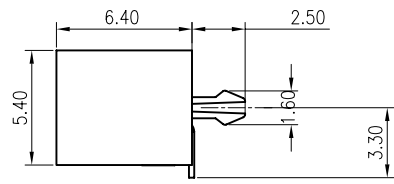
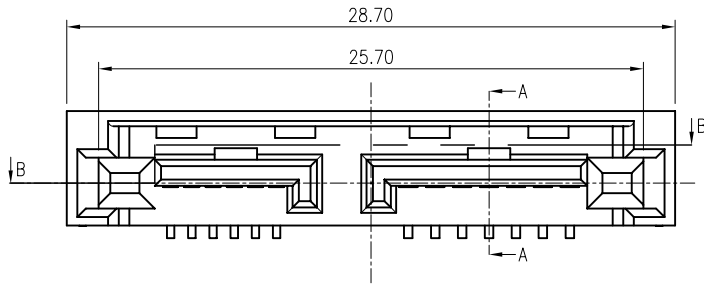

RECOMMEND PCB LAYOUT
PCB TOLERANCE:±0.05

G/F	09-0154-01
MIN. GOLD THICKNESS	PART NUMBER

TOLERANCES UNLESS OTHERWISE SPECIFIED	
X. ±0.30	X." ±2"
.X ±0.25	X.X" ±1"
.XX ±0.15	
.XXX ±0.10	

JS HAOGUO(Zhongxiang) Limited Company

Company Drawing
TITEL: SLIMLINE SATA 7+6 PLUG CONNECTOR

ECN(DCN) NO.	REV.	DATE	DESCRIPTION	CHANGE	APVD	APVD	DAVID_ZHONG	UNIT	mm	SIZE	A4	Third Angle Projection
	A	28/APR/14	RELEASED	KUANG	DZ	CHKD	CIYONG_JIANG	Part No.		Scale	1 of 1	
								Drawing No.	C-09-0154	Sheet	1 of 1	