

TOLERANCE: ±0.05, THICKNESS: 1mm
RECOMMENDED PCB LAYOUT

NOTES:

- MATERIAL:
HOUSING: LCP WITH 30% GF, UL 94V-0, BLACK COLOR.
CAP: LCP WITH 30% GF, UL 94V-0, BLACK COLOR.
CONTACTS: PHOSPHOR BRONZE.
BOARDLOCKS: BRASS.

- FINISH:
CONTACTS: (SEE TABLE)MIN. GOLD PLATED ON CONTACT AREA; 100μ" MIN. MATTE-TIN ON SOLDER TAIL, WITH ENTIRE CONTACT UNDER PLATED 50μ" MIN. NICKEL.
BOARDLOCKS: 100μ" MIN. MATTE-TIN OVER 50μ" MIN. NICKEL ON ENTIRE BOARDLOCK.

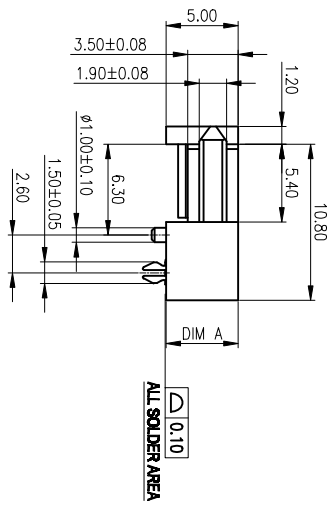
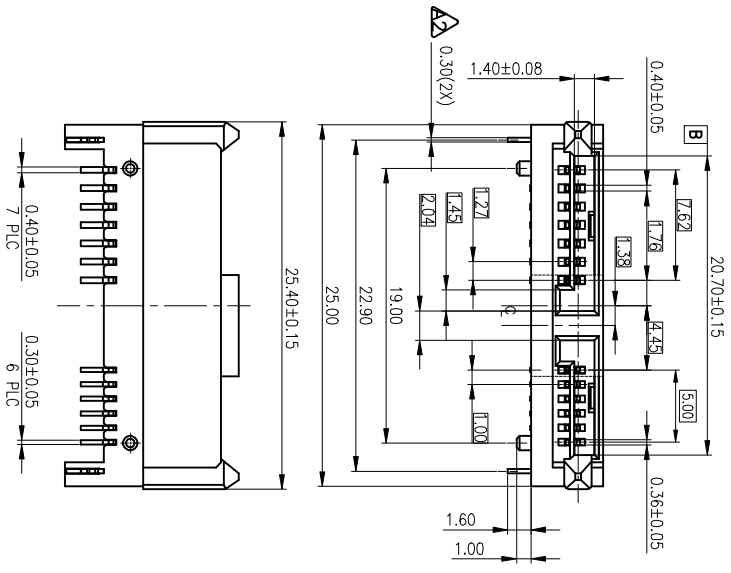

TABLE:

Environmental standard	CAP	GOLD THICKNESS	DIM A	PART NUMBER
Halogen Free		G/F	5.0	09-0076-07
RoSH	WITH/OUT	G/F	5.0	09-0076-06
GP	WITH/OUT	G/F	3.5	09-0076-05-H
RoSH	WITH	15μ"	5.0	09-0076-04
		G/F	5.0	09-0076-03
	WITH/OUT	15μ"	3.5	09-0076-02
		G/F	3.5	09-0076-01

TOLERANCES UNLESS OTHERWISE SPECIFIED
X: ±0.30 X': ±2"
XX: ±0.15 X'X': ±1"
XXX: ±0.10

ECN(DCN) NO.	REV.	DATE	DESCRIPTION	CHANGE	APVD	APVD	APVD	UNIT	mm	SIZE	A4	Third Angle Projection
	A3	19JUN14		KUANG	D.Z	CHKD	DAVID_ZHONG	Drawing No.	C-09-0076			Sheet 1 of 1
	A2	21NOV12		lee	WZ	CHKD	CYONG_JIANG	Part NO.				Scale 1 : 1
	A1	06NOV12		lee	WZ	CHKD	CYONG_JIANG	Drawing No.	C-09-0076			Sheet 1 of 1

JS HAOGUO(Zhongxiang) Limited Company
SATA CONNECTOR, 13 POSITION, RIGHT ANGLE, SMT.