

ROHS

REV.	DESCRIPTION	DATE	DWN	APVD
1	RELEASED	23MAR11	MO	JY

**Material:**

Housing: 30% Glass filled PBT UL94V-0.

Contacts: Phosphor Bronze

Lock: Phosphor Bronze.

**Electrical Characteristics:**

Current Rating: 2 AMP.

Dielectric Withstanding Voltage: AC 1000V For 1 minute.

Insulator Resistance: 1000MΩmin. at DC 500V.

Contact Resistance: 30mΩmax. at DC 100mA.

Operating Temperature: -55°C~+105°C.

**\*RoHS Compliant**

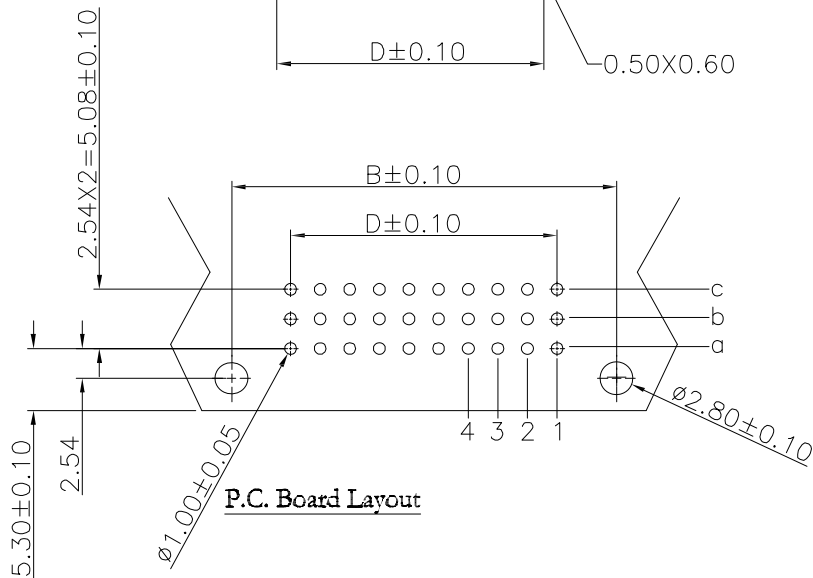
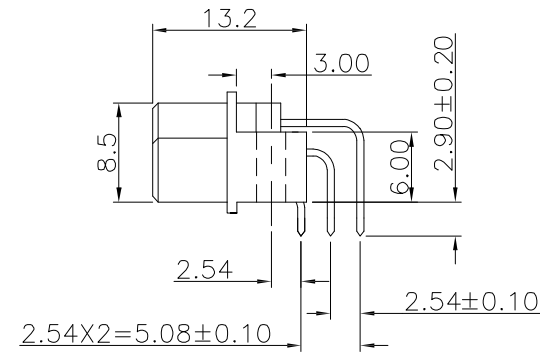
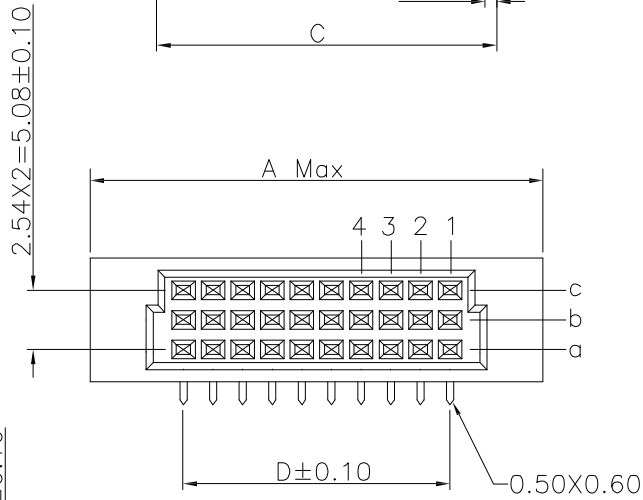
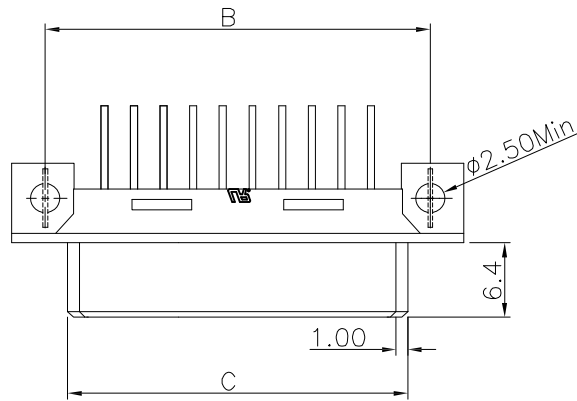

POSITION	A	B	C	D	PART No.
30	38.8	33.02	29.20	22.86	J99-0039-01

TOLERANCES UNLESS OTHERWISE SPECIFIED:		DWN: ciyong		23MAR2011	
0 PLC	± 0.50	CHK		<b>Zhongxiang Electron Science CO.,LTD</b>	
1 PLC	± 0.25	APVD			
2 PLC	± 0.15	PRODUCT SPEC			
3 PLC	± 0.10	APPLICATION SPEC			
4 PLC	± 0.10	MATERIAL		NAME	
ANGLES	± -	SEE NOTE		DIN41612 HALF C TYPE FEMALE	
FINISH		SEE NOTE		SIZE	DRAWING NO
PROJECTION		SEE NOTE		A3	J99-0039
PROJECTOR		WEIGHT		RESTRICTED TO	
DIMENSIONS:		MM		CUSTOMER DRAWING	SCALE
				SHEET	1 of 1
				REV	1