

REV	DESCRIPTION	DATE	DWN	APVD
A2		21Jan10	BEN	DZ
A3		29June11	Lee	WZ

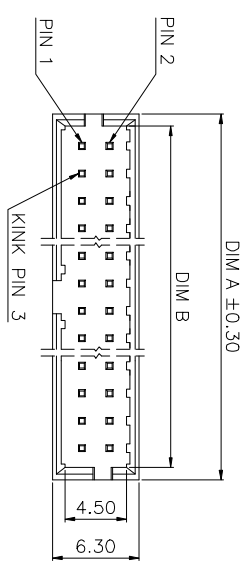

- NOTES:
1. MATERIAL: HOUSING: PA6T WITH 30% GF, UL94V-0; BLACK COLOR. POSTS: COPPER ALLOY .
 2. FINISH: POSTS: 0.8 μ " MIN. GOLD FLASH OVER 50 μ " MIN. NICKEL PLATED.
 3. ELECTRICAL: CONTACT RESISTANCE: 30 m Ω MAX. DIELECTRIC WITHSTANDING VOLTAGE: 1000V AC. CURRENT RATING: 3 A .
 4. ENVIRONMENTAL: OPERATING TEMPERATURE: -55°C TO +105°C .

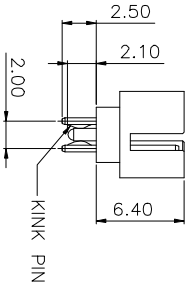
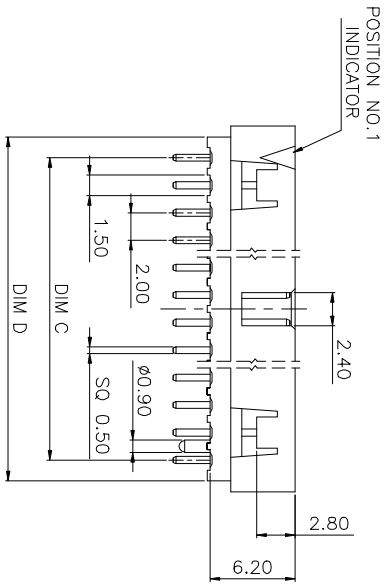

N/A FOR 14 - 50 POS

TYPE II FOR 8,10,12,20 POS

TYPE III FOR 8,10,12,20 POS

TYPE	DIM D	DIM C	DIM B	DIM A	KINK PIN	POSTS	LACK	NO.	PART NUMBER (OLD)	PART NUMBER
N/A	21.00	18.00	20.85	22.65	-	19	20			04-0005-08
	45.00	42.00	44.85	46.65	-	44				04-0005-08
III	11.00	8.00	10.85	12.65	-	10				04-0005-07
	9.00	6.00	8.85	10.65	3, 6	8				04-0005-06
	25.00	22.00	24.85	26.65	3, 22	24				04-0005-05
N/A	25.00	22.00	24.85	26.65	3, 22	12	24			04-0005-04
	17.00	14.00	16.85	18.65	3, 14	16				04-0005-03
	15.00	12.00	14.85	16.65	3, 12	14				04-0005-02
II	11.00	8.00	10.85	12.65	-	10				04-0005-01

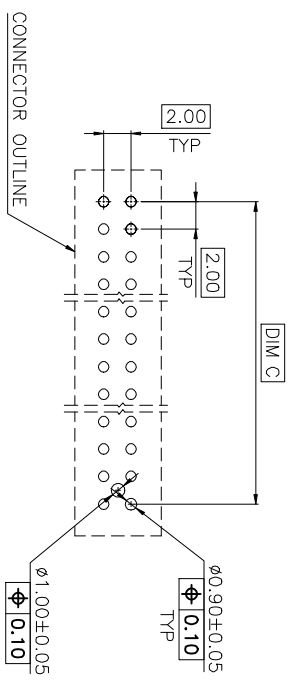

TOLERANCE: ± 0.05 ,
RECOMMENDED PCB LAYOUT
(TOP VIEW)

Zhongxiang Electron Science CO.,LTD

NAME: **BOX HEADER, DOUBLE ROW, VERTICAL, DIP.**

DATE: 29June2011

APVD: BEN

CHK: Ben Chen

APVD: Govin Chen

APVD: Wei Zhang

PRODUCT SPEC: JS-CC03135-A1

APPLICATION SPEC: BOX HEADER_01-1(A)

FINISH: SEE NOTE

PROJECTION: SEE NOTE

WEIGHT: MM

SIZE: A3

DRAWING NO: C-04-0005

CUSTOMER DRAWING: SCALE: 1 OF 1

RESTRICTED TO: A3

8 7 6 5 4 3 2 1